



Melville Street | | Ryde | PO33 2AN

£950 PCM



Melville Street |  
Ryde | PO33 2AN  
£950 PCM

AVAILABLE START OF APRIL!! This beautifully presented two bedroom ground floor apartment is located in the popular town of Ryde, within walking distance to Ryde town centre, sandy beaches and ferry links to Portsmouth. The Georgian apartment consists of a good-sized living room, kitchen, two double bedrooms and shower room. Outside offers a courtyard garden. Other benefits of the property includes an allocated parking space, double glazed windows throughout and gas central heating. PLEASE CONTACT US FOR A VIDEO TOUR!

- AVAILABLE START OF APRIL
- 2 BEDROOMS
- GROUND FLOOR APARTMENT
- GARDEN
- WALKING DISTANCE TO BEACH & TOWN CENTRE
- PARKING
- FURNISHED OR PARTIALLY FURNISHED

## Entrance Hall

## Living Room

12'11" x 20'9" (3.94 x 6.32)

## Kitchen

6'7" x 11'0" (2.01 x 3.35)

## Bedroom 1

10'7" x 9'4" (3.23 x 2.84)

## Bedroom 2

10'7" x 9'4" (3.23 x 2.84)

## Shower Room

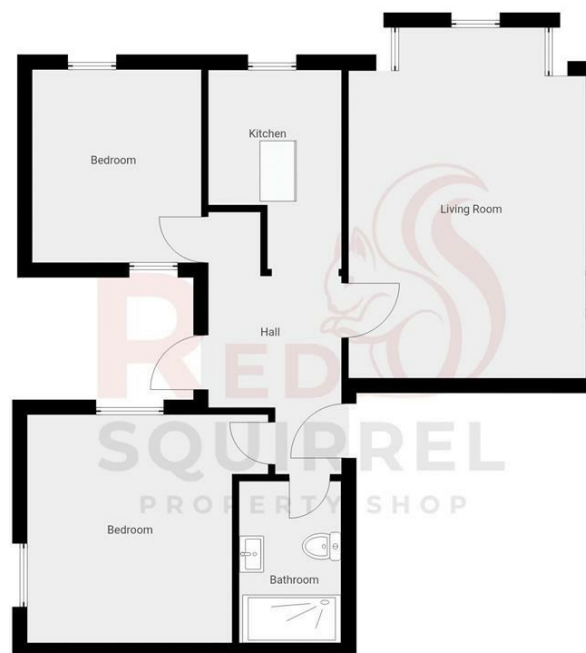

Energy Efficiency Rating		
	Current	Potential
Very energy efficient - lower running costs		
(92 plus) A		
(81-91) B		
(69-80) C		77
(55-68) D	62	
(39-54) E		
(21-38) F		
(1-20) G		
Not energy efficient - higher running costs		
England & Wales	EU Directive 2002/91/EC	

Council Tax Band **B**  
EPC Rating **D**

3 Langely Court Pyle Street  
Newport  
Isle of Wight  
PO30 1LA  
01983 521212

enquiries@redsquirrelpropertyshop.co.uk  
www.redsquirrelpropertyshop.co.uk

THIS FLOOR PLAN IS PROVIDED WITHOUT WARRANTY OF ANY KIND. REDSQUIRREL PROPERTY SHOP DISCLAIMS ANY WARRANTY INCLUDING, WITHOUT LIMITATION, SATISFACTORY QUALITY OR ACCURACY OF DIMENSIONS.